

What we plan to do

Kent County Council (KCC) are planning to make alterations to the Wellington Crescent northbound bus stop to enable easier movements for the bus and better access for passengers to board and alight. This will be achieved by building out to extend the kerb of the bus stop at the junction of Plains of Waterloo. There will be no loss to parking as part of this scheme, only the relocation of two spaces currently situated on the southbound approach to the northbound side.

Why are we doing this work?

KCC has reviewed the performance of the Thanet Loop Bus Service, which connects Margate, Ramsgate and Broadstairs. As part of this process, a package of highway improvements has been developed to reduce bus journey times, increase reliability, and improve accessibility at bus stops. Several locations on the road network were identified as having a negative impact on bus and passenger access and where there would be benefit in making improvements.

A first public consultation for the proposed changes at this stop took place between 20 February to 12 March 2024, followed by a second between 16 October to 30 October 2024. Letters were delivered to properties located nearby to inform businesses and residents and invite them to submit any comments to KCC. A decision has been taken by KCC to proceed with this improvement.

When we plan to carry out the work and how long it will take

Works to the bus stop are due to commence on Monday 17th February and the construction of the new build-out is anticipated to take a duration of five days until Friday 21st February. This work will typically be undertaken during the hours of 8am until 5pm.

Once bus stop works have been constructed, the road surface surrounding the new build-out along Wellington Crescent and Plains of Waterloo also needs to be renewed. We are also taking an opportunity resurface longer sections of carriageway which are currently in poor condition. To do this work safely, we will need to close a section of Wellington Crescent and Plains of Waterloo overnight.

Resurfacing works will be taking place at this location overnight during the hours of 22:00 – 05:00 on **Monday 24th and Tuesday 25th February**. Access by road to Wellington Crescent and Plains of Waterloo will be restricted during this time with limited parking available on street parking available overnight, pedestrian access will be maintained. A road closure and diversion will be in place to facilitate these works:

For traffic heading towards Ramsgate via the B2054 London Road the diversion route will be:

**Grange Road,
A255 Park Road,
Boundary Road,
Victoria Road**

For traffic heading towards Ramsgate via Wellington Crescent the diversion route will be:

**Victoria Road,
Boundary Road,
A255 Park Road,
Grange Road,
B2054 St Augustine's Road,
Royal Parade,
Harbour Parade**

Please note, work progress can be affected by bad weather, so the duration and dates may be subject to change at short notice.



If the scheme proceeds it will be fully funded by a Department of Transport (DfT) grant through the Bus Service Improvement Plan (BSIP), which is being provided by central government for a series of bus improvements throughout Kent.



How will we carry out the works and how will it affect you?

The work on the bus stop will be undertaken using lane closures and temporary traffic signals to give our contractor a safe area within which to carry out necessary construction works. The temporary traffic lights will be in place for the duration of the construction and will be manually controlled by a traffic management operative between 7am and 7pm to manage and monitor to the traffic flows.

This work will require some on-street parking suspensions for the duration of the works. Ahead of work starting, our contractors will be putting down no waiting cones to prevent parking in certain areas where we will need to occupy. Pedestrian access to properties will be maintained during this time.

Clements Road southbound northbound bus stop will also be suspended for the duration of the works, signage will be posted at this stop to reflect this.

Please note, that carriageway resurfacing is likely to generate some noise at night time, therefore we apologise in advance for any inconvenience caused whilst we undertake these essential maintenance works.

How you can help us

We need your help to make sure the work is done as quickly as possible and to the best possible quality, without causing you too much inconvenience. If your vehicle is usually parked on the carriageway, please make sure you park it somewhere else away from the site whilst the works are carried out as advised by cones and notices on site.

If you have any questions about the project, would like any further information, or have any specific needs to discuss about the construction, please email thanetloopimprovementproject@kent.gov.uk where a member of the project team would be happy to assist.

For your safety and the safety of our workforce, please drive carefully near the roadworks. Feedback from our workers shows that too many drivers go too fast through roadworks. Everyone is entitled to a safe workplace and our staff work next to moving traffic and risk injury every day to maintain and improve the highway for everyone.

How to contact us?

For further information or to find out more about what we do please visit our website www.kent.gov.uk/highways where you can also report a fault on any of our roads across Kent. You can find us on X (formerly Twitter) @KentHighways. You can also view our diversion/permit details at www.one.network. Alternatively, you can call us on **03000 41 81 81**. We often ask residents to fill in a short feedback survey online at www.kent.gov.uk/roadworkssurvey.

WARNING – Beware Bogus Callers

Kent County Council Highways, Transportation and Waste do not allow works to be carried out on private properties. If anyone says they are working for us or our specialist contractors and offer to carry out any work for cash, they should be treated with caution. We advise you to contact Citizen's Advice on 03444 111 444 (Monday to Friday 9.00am to 5.00pm)



If the scheme proceeds it will be fully funded by a Department of Transport (DfT) grant through the Bus Service Improvement Plan (BSIP), which is being provided by central government for a series of bus improvements throughout Kent.



Bus stop build-out at Wellington Crescent northbound bus stop

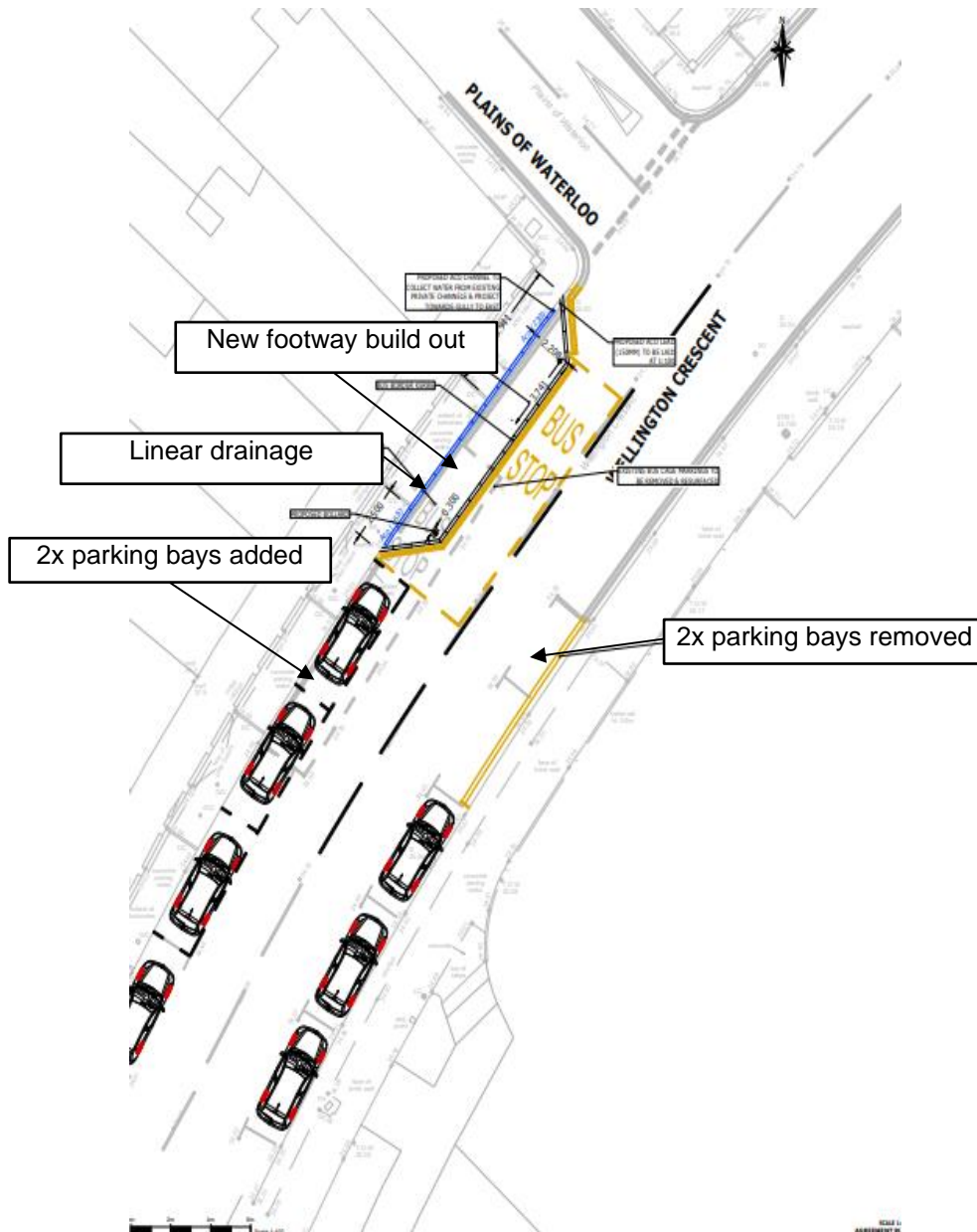

If the scheme proceeds it will be fully funded by a Department of Transport (DfT) grant through the Bus Service Improvement Plan (BSIP), which is being provided by central government for a series of bus improvements throughout Kent.



Area of carriageway to be resurfaced on Wellington Crescent / Plains of Waterloo

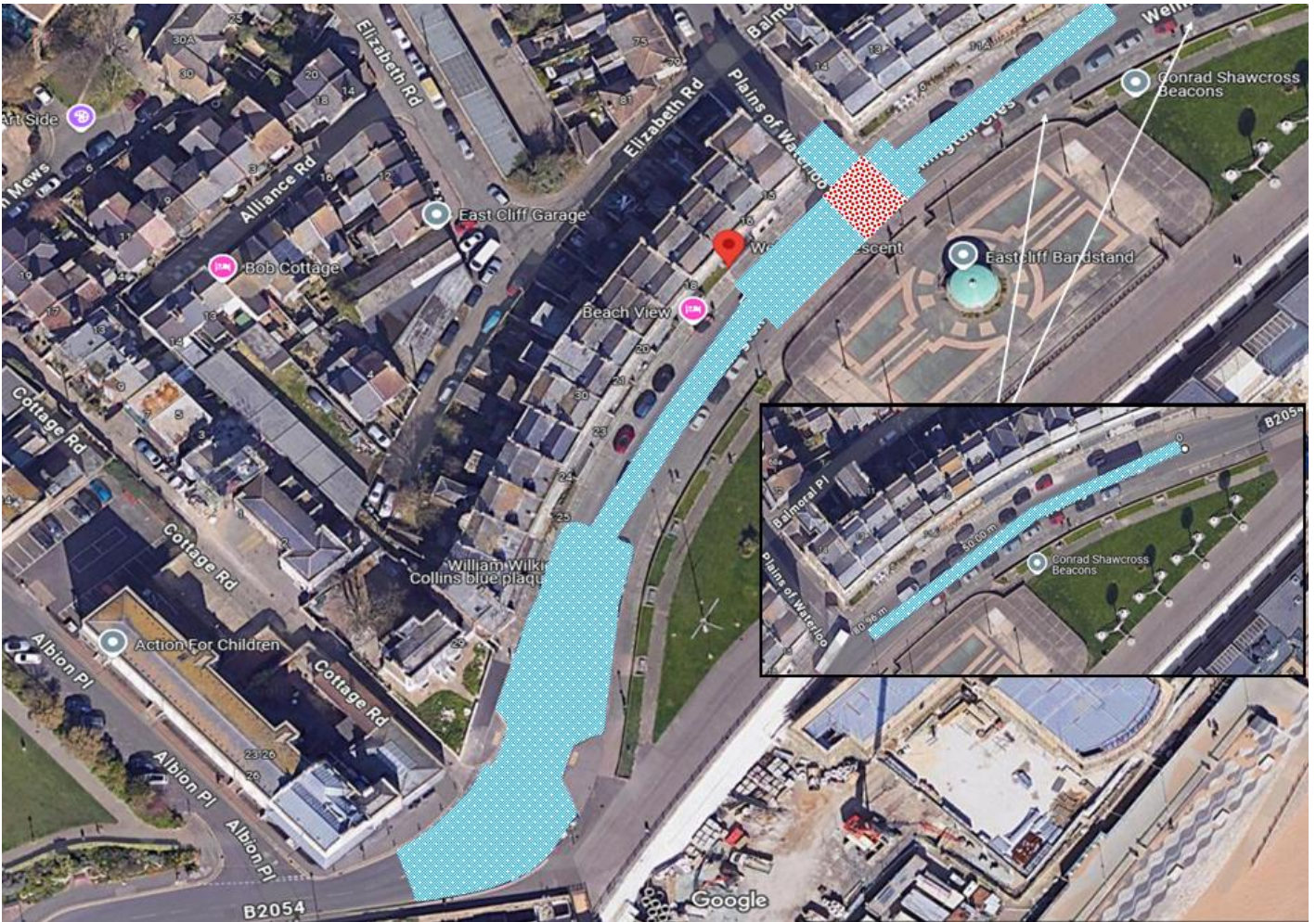

If the scheme proceeds it will be fully funded by a Department of Transport (DfT) grant through the Bus Service Improvement Plan (BSIP), which is being provided by central government for a series of bus improvements throughout Kent.

